

A-M

CAPICORDA CON ATTACCO CONTENUTO

per interruttori automatici B.T.
per cavi in rame



File no. E125401

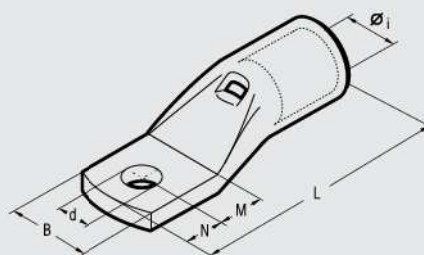

Aventi le medesime caratteristiche dei capicorda tipo A-M, questi capicorda sono caratterizzati da una ridotta larghezza di patella d'attacco.

Sono stati studiati e realizzati appositamente per il collegamento di apparecchiature che hanno morsetti dimensionalmente non adeguati ad accogliere i capicorda di normali dimensioni.

Sezione Cavo Flessibile mm ²	Ø Vite mm	Tipo	Dimensioni mm							Imballo standard/minimo	Utensili Meccanici	Utensili Oleodinamici
			Øi	B	M	N	L	d				
10	5	A 2-M 5/9	4,6	9,0	6,5	6,0	26,0	5,3	1000/100	HNB HN-A25 TN 71	B 15D	
16	5	A 3-M 5/9	5,8	9,0	6,5	6,0	29,0	5,3	1000/100			
25	5	A 5-M 5/9	7,0	9,0	6,5	6,0	31,5	5,3	500/100			
35	6	A 7 B-M 6/11.5	8,9	11,5	8,0	7,0	36,5	6,4	400/100	TN 120 S	B 35-45D B 35-50D HT 45	
50	6	A 10 B-M 6/11.5	10,0	11,5	8,0	7,0	40,5	6,4	200/50			
70	6	A 14 B-M 6/11.5	11,3	11,5	8,0	7,0	44,0	6,4	200/50	TN 120 S	HT 51 RH 50 B 51	
95	8	A 19 B-M 8/15.5	13,5	15,5	9,0	8,0	52,5	8,4	100/25			
120	8	A 24 B-M 8/19	15,2	19,0	14,0	9,0	60,0	8,4	100/25	TN 120 S	HT 51 RH 50 B 51 HT 81-U RHU 81	
	10	A 24 B-M 10/19	15,2	19,0	14,0	9,0	60,0	10,5	100/25			
150	8	A 30 B-M 8/19	16,7	19,0	18,0	9,0	70,0	8,4	50/25	TN 120 S	HT 51 RH 50 B 51 HT 81-U RHU 81	
	10	A 30 B-M 10/19	16,7	19,0	18,0	9,0	70,0	10,5	50/25			
185	10	A 37 B-M 10/24.5	19,2	24,5	18,0	9,0	77,0	10,5	50/25	TN 120 S	HT 51 RH 50 B 51 HT 81-U RHU 81	
	10	A 48-M 10/31	21,1	31,0	13,0	9,0	80,0	10,5	30/15			
240	12	A 48-M 12/31	21,1	31,0	16,0	12,0	86,0	13,2	30/15	TN 120 S	HT 51 RH 50 B 51 HT 81-U RHU 81	
	16	A 48-M 16/31	21,1	31,0	19,0	17,0	94,0	17,0	30/15			
300	10	A 60 B-M 10/31	23,7	31,0	16,0	12,0	95,0	10,5	20/10	TN 120 S	HT 51 RH 50 B 51 HT 81-U RHU 81	
	12	A 60 B-M 12/31	23,7	31,0	16,0	12,0	95,0	13,2	20/10			

