

ANE-M

CAPICORDA PREISOLATI IN PA 6.6

per cavi in rame

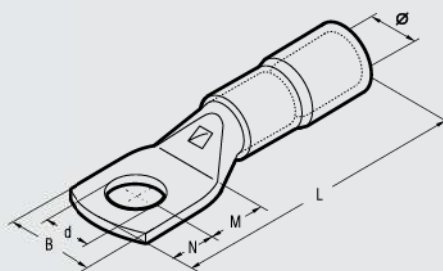

I capicorda della serie ANE-M sono studiati per cablaggi di quadri elettrici di potenza, dove vengono impiegati cavi di tipo flessibile. Sono ricavati da tubo di rame elettrolitico di sezione tale da garantire sia una buona connessione elettrica che un'adeguata resistenza meccanica alla trazione; sono ricotti e protetti superficialmente mediante stagatura elettrolitica.

Il rivestimento isolante in PA 6.6 semplifica le operazioni di installazione e di ripristino dell'isolante del cavo; inoltre, internamente è sagomato a forma di imbuto per assicurare una facile e completa inserzione del conduttore nel colletto del capocorda.

La temperatura di utilizzo è da -20°C a +115°C (+130°C per brevi transitori).

I capicorda tipo ANE 2, ANE 3, ANE 5 possono essere impiegati anche su cavi rigidi se compressi con le matrici a contenimento radiale della serie MN...RF-C (pag. 196-197).

Sezione cavo mm	Ø Vite mm	Tipo	Dimensioni mm							Imballo standard/minimo	Utensili Meccanici	Utensili Oleodinamici	
			Øi	B	M	N	L	d					
10	4	ANE 2-M 4	8,0	10,0	5,0	4,0	34,1	4,3	500/100	HN3 HN4	B 150		
	5	ANE 2-M 5	8,0	10,0	6,5	6,0	37,6	5,3	500/100				
	6	ANE 2-M 6	8,0	11,0	7,0	6,0	38,1	6,4	500/100				
	8	ANE 2-M 8	8,0	15,0	9,0	8,0	42,1	8,4	500/100				
	10	ANE 2-M 10	8,0	18,0	11,0	10,0	46,1	10,5	500/100				
	12	ANE 2-M 12	8,0	19,0	14,0	12,0	51,1	13,2	500/100				
16	4	ANE 3-M 4	9,2	11,5	5,0	4,0	38,6	4,3	500/100	HN3 HN4	B 150		
	5	ANE 3-M 5	9,2	11,5	6,5	6,0	42,1	5,3	500/100				
	6	ANE 3-M 6	9,2	11,5	7,0	6,0	42,6	6,4	500/100				
	8	ANE 3-M 8	9,2	15,0	9,0	8,0	46,6	8,4	500/100				
	10	ANE 3-M 10	9,2	18,0	11,0	10,0	50,6	10,5	400/100				
	12	ANE 3-M 12	9,2	20,0	14,0	12,0	55,6	13,2	300/100				
25	4	ANE 5-M 4	11,1	14,0	5,0	4,0	41,0	4,3	300/100	TN 70 TN 71	B 35-500		
	5	ANE 5-M 5	11,1	14,0	6,5	6,0	44,5	5,3	300/100				
	6	ANE 5-M 6	11,1	14,0	7,0	6,0	45,0	6,4	300/100				
	8	ANE 5-M 8	11,1	15,0	9,0	8,0	49,0	8,4	300/100				
	10	ANE 5-M 10	11,1	18,0	11,0	10,0	53,0	10,5	300/100				
	12	ANE 5-M 12	11,1	21,0	14,0	12,0	58,0	13,2	250/50				
35	6	ANE 7-M 6	13,6	17,0	7,0	6,0	50,0	6,4	200/50	TN 120	HT 51 RH 50 B 51	ECW-H3D	
	8	ANE 7-M 8	13,6	17,0	9,0	8,0	54,0	8,4	200/50				
	10	ANE 7-M 10	13,6	19,0	11,0	10,0	58,0	10,5	200/50				
	12	ANE 7-M 12	13,6	21,0	14,0	12,0	63,0	13,2	200/50				
	6	ANE 10-M 6	13,8	19,0	8,0	7,0	55,0	6,4	200/50				
	8	ANE 10-M 8	13,8	19,0	9,0	8,0	57,0	8,4	200/50				
50	10	ANE 10-M 10	13,8	20,0	11,0	10,0	61,0	10,5	150/50	TN 120	HT 120 ed utensili e teste della linea 130 kV	ECW-H3D	
	12	ANE 10-M 12	13,8	21,0	14,0	12,0	66,0	13,2	150/50				
	8	ANE 14-M 6	15,8	21,0	8,0	7,0	61,0	6,4	100/25				
	8	ANE 14-M 8	15,8	21,0	9,0	8,0	63,0	8,0	100/25				
	10	ANE 14-M 10	15,8	21,0	11,0	10,0	67,0	10,5	100/25				
	12	ANE 14-M 12	15,8	22,0	14,0	12,0	72,0	13,2	100/25				
70	14	ANE 14-M 14	15,8	25,0	16,0	14,0	76,0	15,0	100/25	TN 120	HT 120 ed utensili e teste della linea 130 kV	ECW-H3D	
	8	ANE 19-M 8	18,0	25,0	9,0	8,0	73,0	8,4	50/25				
	10	ANE 19-M 10	18,0	25,0	11,0	10,0	77,0	10,5	50/25				
	12	ANE 19-M 12	18,0	25,0	14,0	12,0	82,0	13,2	50/25				
	14	ANE 19-M 14	18,0	25,0	16,0	14,0	86,0	15,0	50/25				
	16	ANE 19-M 16	18,0	27,0	18,0	16,0	90,0	17,0	50/25				
120	10	ANE 24-M 10	20,0	28,5	11,0	10,0	77,7	10,5	50/25	TN 120	HT 120 ed utensili e teste della linea 130 kV	ECW-H3D	
	12	ANE 24-M 12	20,0	28,5	14,0	12,0	86,5	13,2	50/25				
	14	ANE 24-M 14	20,0	28,5	16,0	14,0	88,5	15,0	50/25				
	16	ANE 24-M 16	20,0	28,5	18,0	16,0	90,5	17,0	50/25				
	12	ANE 30-M 12	23,0	31,5	16,0	14,0	101,0	13,2	30/15				
	14	ANE 30-M 14	23,0	31,5	18,0	16,0	105,0	15,0	30/15				
150	16	ANE 30-M 16	23,0	31,5	19,0	17,0	107,0	17,0	30/15	TN 120	HT 120 ed utensili e teste della linea 130 kV	ECW-H3D	
	20	ANE 30-M 20	23,0	31,5	22,0	20,0	113	21,0	30/15				