

A-M



CAPICORDA

per conduttori in rame



File no. E125401

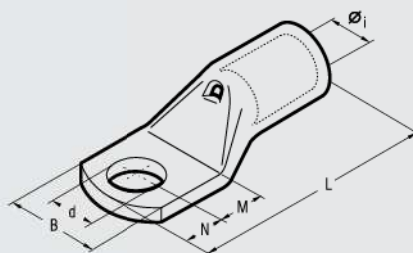

I capicorda della serie A-M sono ricavati da tubo di rame elettrolitico di sezione tale da garantire sia una buona connessione elettrica che un'adeguata resistenza alla trazione.

Sono ricotti e protetti superficialmente mediante stagnatura elettrolitica.

Il processo di ricottura ottimizza le caratteristiche strutturali del materiale, permette quindi una compressione più agevole e garantisce l'utilizzo del capocorda in presenza di sollecitazioni meccaniche di varia natura.

Il colletto è provvisto di smusso e foro d'ispezione per una facile e corretta introduzione del conduttore; la sua lunghezza inoltre è tale da rendere agevole e preciso il posizionamento all'interno delle matrici degli utensili.

Ogni capocorda riporta incisi:

- marchio di fabbrica e numero di catalogo Cembre.
- natura e sezione del conduttore (mm²).
- Ø della vite (mm).

A richiesta possono essere forniti capicorda con attacco a due o più fori.

Sezione Conduttore mm ²	Ø Vite mm	Tipo	Dimensioni mm						Imballo standard/minimo	Utensili Meccanici	Utensili Oleodinamici
			Rigido	Flex	Øi	B	M	N			
0,25÷1,5	3	A 03-M 3	1,8	6,0	4,5	3,5	16,0	3,2	5.000/100	HN1	B 150
	3,5	A 03-M 3.5	1,8	6,5	4,5	3,5	16,0	3,7	5.000/100		
	4	A 03-M 4	1,8	6,5	5,0	4,0	17,0	4,3	5.000/100		
	5	A 03-M 5	1,8	7,5	5,5	4,5	18,0	5,3	5.000/100		
	6	A 03-M 6	1,8	9,0	6,0	5,0	19,0	6,4	5.000/100		
1,5÷2,5	3	A 06-M 3	2,4	6,0	4,5	3,5	17,0	3,2	4.000/100		
	3,5	A 06-M 3.5	2,4	6,5	4,5	3,5	17,0	3,7	4.000/100		
	4	A 06-M 4	2,4	7,5	5,0	4,0	18,0	4,3	4.000/100		
	5	A 06-M 5	2,4	8,5	5,5	4,5	19,0	5,3	4.000/100		
	6	A 06-M 6	2,4	9,0	6,0	5,0	20,0	6,4	4.000/100		
4÷6	8	A 06-M 8	2,4	12,0	9,0	8,0	26,0	8,4	2.500/100		
	3	A 1-M 3	3,6	7,5	4,5	3,5,0	20,5	3,2	2.000/100		
	3,5	A 1-M 3.5	3,6	7,5	4,5	3,5	20,5	3,7	2.000/100		
	4	A 1-M 4	3,6	8,0	5,0	4,0	21,5	4,3	2.000/100		
	5	A 1-M 5	3,6	9,0	6,5	6,0	25,0	5,3	2.000/100		
10	6	A 1-M 6	3,6	11,0	7,0	6,0	25,5	6,4	2.000/100		
	8	A 1-M 8	3,6	14,0	9,0	8,0	29,5	8,4	1.500/100		
	10	A 1-M 10	3,6	16,5	11,0	10,0	33,5	10,5	1.000/100		
	4	A 2-M 4	4,6	10,0	5,0	4,0	22,5	4,3	1.500/100		
	5	A 2-M 5	4,6	10,0	6,5	6,0	26,0	5,3	1.500/100		
16	6	A 2-M 6	4,6	11,0	7,0	6,0	26,5	6,4	1.500/100		
	8	A 2-M 8	4,6	15,0	9,0	8,0	30,5	8,4	1.000/100		
	10	A 2-M 10	4,6	18,0	11,0	10,0	34,5	10,5	1.000/100		
	12	A 2-M 12	4,6	19,0	14,0	12,0	39,5	13,2	500/100		
	4	A 3-M 4	5,8	11,5	5,0	4,0	25,5	4,3	1.000/100		
25	5	A 3-M 5	5,8	11,5	6,5	6,0	29,0	5,3	1.000/100		
	6	A 3-M 6	5,8	11,5	7,0	6,0	29,5	6,4	1.000/100		
	8	A 3-M 8	5,8	15,0	9,0	8,0	33,5	8,4	500/100		
	10	A 3-M 10	5,8	18,0	11,0	10,0	37,5	10,5	500/100		
	12	A 3-M 12	5,8	20,0	14,0	12,0	42,5	13,2	500/100		
35	4	A 5-M 4	7,0	14,0	5,0	4,0	28,0	4,3	1.000/100		
	5	A 5-M 5	7,0	14,0	6,5	6,0	31,5	5,3	500/100		
	6	A 5-M 6	7,0	14,0	7,0	6,0	32,0	6,4	500/100		
	8	A 5-M 8	7,0	15,0	9,0	8,0	36,0	8,4	500/100		
	10	A 5-M 10	7,0	18,0	11,0	10,0	40,0	10,5	500/100		
50	12	A 5-M 12	7,0	21,0	14,0	12,0	45,0	13,2	500/100		
	5	A 7-M 5	8,9	17,0	6,5	6,0	34,0	5,3	500/100		
	6	A 7-M 6	8,9	17,0	7,0	6,0	34,5	6,4	500/100		
	8	A 7-M 8	8,9	17,0	9,0	8,0	38,5	8,4	400/100		
	10	A 7-M 10	8,9	19,0	11,0	10,0	42,5	10,5	400/100		
70	12	A 7-M 12	8,9	21,0	14,0	12,0	47,5	13,2	300/50		
	6	A 10-M 6	10,0	19,0	8,0	7,0	40,5	6,4	200/50		
	8	A 10-M 8	10,0	19,0	9,0	8,0	42,5	8,4	200/50		
	10	A 10-M 10	10,0	20,0	11,0	10,0	46,5	10,5	200/50		
	12	A 10-M 12	10,0	21,0	14,0	12,0	51,5	13,2	200/50		
	14	A 10-M 14	10,0	25,0	16,0	14,0	55,5	15,0	200/50		
	16	A 10-M 16	10,0	26,0	18,0	16,0	59,5	17,0	200/50		
	6	A 14-M 6	11,3	21,0	8,0	7,0	44,0	6,4	200/50		
	8	A 14-M 8	11,3	21,0	9,0	8,0	46,0	8,4	200/50		
	10	A 14-M 10	11,3	21,0	11,0	10,0	50,0	10,5	200/50		
	12	A 14-M 12	11,3	22,0	14,0	12,0	55,0	13,2	150/50		
	14	A 14-M 14	11,3	25,0	16,0	14,0	59,0	15,0	100/50		
	16	A 14-M 16	11,3	26,0	18,0	16,0	63,0	17,0	100/50		



File no. E125401

CAPICORDA

per conduttori in rame

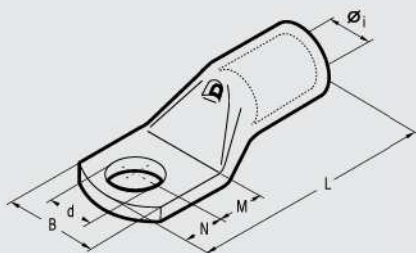
A-M

Sezione Conduttore mm ²		Tipo	Dimensioni mm							Imballo standard/minimo	Utensili Meccanici	Utensili Oleodinamici
Rigido	Flex		Øi	B	M	N	L	d				
95	70 95	6	A 19-M 6	13,5	25,0	8,0	7,0	50,5	6,4	100/25	TN 120 S	B 35-450 B 35-500 HT 45
		8	A 19-M 8	13,5	25,0	9,0	8,0	52,5	8,4	100/25		
		10	A 19-M 10	13,5	25,0	11,0	10,0	56,5	10,5	100/25		
		12	A 19-M 12	13,5	25,0	14,0	12,0	61,5	13,2	100/25		
		14	A 19-M 14	13,5	25,0	16,0	14,0	65,5	15,0	100/25		
		16	A 19-M 16	13,5	27,0	18,0	16,0	69,5	17,0	100/25		
120	95 120	20	A 19-M 20	13,5	29,5	22,0	20,0	77,5	21,0	50/25	HT 51 RH 50 B 51 HT 81-U RHU 81	
		8	A 24-M 8	15,2	28,5	9,0	8,0	54,0	8,4	100/25		
		10	A 24-M 10	15,2	28,5	11,0	10,0	58,0	10,5	100/25		
		12	A 24-M 12	15,2	28,5	14,0	12,0	63,0	13,2	100/25		
		14	A 24-M 14	15,2	28,5	16,0	14,0	67,0	15,0	50/25		
		16	A 24-M 16	15,2	28,5	18,0	16,0	71,0	17,0	50/25		
150	120 150	20	A 24-M 20	15,2	30,0	22,0	20,0	79,0	21,0	50/25	HT 120 ed utensili e teste della linea 130 kV ECW-H3D RHU 520	
		8	A 30-M 8	16,7	31,5	13,0	11,0	69,0	8,4	50/25		
		10	A 30-M 10	16,7	31,5	13,0	11,0	69,0	10,5	50/25		
		12	A 30-M 12	16,7	31,5	16,0	14,0	75,0	13,2	50/25		
		14	A 30-M 14	16,7	31,5	18,0	16,0	79,0	15,0	50/25		
		16	A 30-M 16	16,7	31,5	19,0	17,0	81,0	17,0	50/25		
185	150 185	20	A 30-M 20	16,7	31,5	22,0	20,0	87,0	21,0	50/25	HT 120 ed utensili e teste della linea 130 kV ECW-H3D RHU 520	
		8	A 37-M 8	19,2	35,5	13,0	11,0	76,0	8,4	50/25		
		10	A 37-M 10	19,2	35,5	13,0	11,0	76,0	10,5	40/20		
		12	A 37-M 12	19,2	35,5	16,0	14,0	82,0	13,2	40/20		
		14	A 37-M 14	19,2	35,5	18,0	16,0	86,0	15,0	30/15		
		16	A 37-M 16	19,2	35,5	19,0	17,0	88,0	17,0	30/15		
240	185 240	20	A 37-M 20	19,2	35,5	22,0	20,0	94,0	21,0	30/15	HT 120 ed utensili e teste della linea 130 kV ECW-H3D RHU 520	
		8	A 48-M 8	21,1	39,0	13,0	11,0	77,5	8,4	30/15		
		10	A 48-M 10	21,1	39,0	13,0	11,0	77,5	10,5	30/15		
		12	A 48-M 12	21,1	39,0	14,0	12,0	79,5	13,2	30/15		
		14	A 48-M 14	21,1	39,0	18,0	16,0	92,0	15,0	30/15		
		16	A 48-M 16	21,1	39,0	19,0	17,0	94,0	17,0	30/15		
300	240 300	20	A 48-M 20	21,1	39,0	22,0	20,0	100,0	21,0	30/15	HT 120 ed utensili e teste della linea 130 kV ECW-H3D RHU 520	
		10	A 60-M 10	23,7	44,0	20,0	11,0	96,0	10,5	20/10		
		12	A 60-M 12	23,7	44,0	20,0	14,0	99,0	13,2	20/10		
		14	A 60-M 14	23,7	44,0	22,0	16,0	103,0	15,0	20/10		
		16	A 60-M 16	23,7	44,0	22,0	19,0	106,0	17,0	20/10		
		20	A 60-M 20	23,7	44,0	24,0	23,0	112,0	21,0	20/10		
400	300 400	12	A 80-M 12	27,0	51,0	22,0	19,0	113,0	13,2	15/5	HT 120 ed utensili e teste della linea 130 kV ECW-H3D RHU 520	
		14	A 80-M 14	27,0	51,0	22,0	19,0	113,0	15,0	20/5		
		16	A 80-M 16	27,0	51,0	22,0	19,0	113,0	17,0	20/5		
		20	A 80-M 20	27,0	51,0	24,0	23,0	119,0	21,0	20/5		
500	400 500	16	A 100-M 16	30,3	56,5	22,0	19,0	117,0	17,0	15/1	HT 120 ed utensili e teste della linea 130 kV ECW-H3D RHU 520	
		20	A 100-M 20	30,3	56,5	24,0	23,0	123,0	21,0	15/1		
630	500 630	16	A 120-M 16	33,4	61,6	22,0	19,0	128,0	17,0	12/1	HT 120 ed utensili e teste della linea 130 kV ECW-H3D RHU 520	
		20	A 120-M 20	33,4	61,6	24,0	23,0	134,0	21,0	10/1		
800	630 800	16	A 160-M 16	38,0	72,0	24,0	19,0	141,0	17,0	6/1	HT 120 ed utensili e teste della linea 130 kV ECW-H3D RHU 520	
		20	A 160-M 20	38,0	72,0	24,0	23,0	145,0	21,0	6/3		
1000	800 1000	16	A 200-M 16	44,0	80,0	24,0	19,0	158,0	17,0	6/1	HT 120 ed utensili e teste della linea 130 kV ECW-H3D RHU 520	
		20	A 200-M 20	44,0	80,0	24,0	23,0	162,0	21,0	6/1		