

CONFIGURAZIONE INTERNA

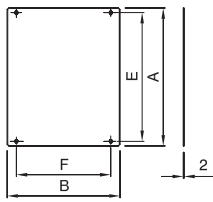

piastre in acciaio

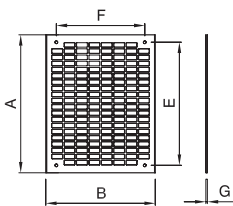

piastre forate in acciaio

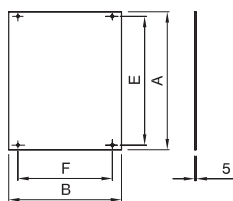

piastre in materiale isolante

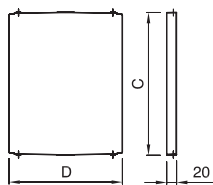

controporta in materiale isolante/
controporta in metallo

| | | | | | | | |
|----------------------------------|-----------|-----------|-----------|-----------|-----------|-----------|------------|
| Piastre in acciaio | GW 46 401 | GW 46 402 | GW 46 403 | GW 46 404 | GW 46 405 | GW 46 406 | GW 46 407 |
| Piastre forate | GW 46 461 | GW 46 462 | GW 46 463 | GW 46 464 | GW 46 465 | GW 46 466 | GW 46 467 |
| Piastre isolate | GW 46 408 | GW 46 409 | GW 46 410 | GW 46 411 | GW 46 412 | GW 46 413 | - |
| Controp. isolante | - | GW 46 414 | GW 46 415 | GW 46 416 | GW 46 417 | GW 46 418 | GW 46 419 |
| Controp. metallo | - | GW 46 564 | GW 46 565 | GW 46 566 | GW 46 567 | GW 46 568 | GW 46 569 |
| Per quadri dimensionali BxH (mm) | 300 x 250 | 425 x 310 | 500 x 405 | 650 x 405 | 650 x 515 | 800 x 585 | 1060 x 800 |
| A | 235 | 359 | 434 | 584 | 584 | 734 | 984 |
| B | 199 | 260 | 355 | 355 | 463 | 535 | 715 |
| C | - | 370 | 445 | 595 | 595 | 745 | 995 |
| D | - | 264 | 357 | 357 | 465 | 537 | 712 |
| E | 203 | 327 | 402 | 552 | 552 | 702 | 952 |
| F | 141 | 202 | 297 | 297 | 405 | 477 | 657 |
| G | 1,5 | 2 | 2 | 2 | 2 | 2 | 2 |

| CARICHI MASSIMI AMMISSIBILI SULLE PIASTRE DI FONDO INSTALLATE NEI QUADRI SERIE 46 (Kg) | | | | | |
|--|-----|-----|-----|------------------|--------------|
| Taglia quadro BxHxP (mm) | QP | QM | QX | Codice piastra | Tipo piastra |
| 250x300x160 | 50 | 42 | | GW 46 401 | Acciaio |
| | 35 | 35 | | GW 46 461 | Forata |
| | 35 | 35 | | GW 46 408 | Isolante |
| 310x425x160 | 70 | 65 | 65 | GW 46 402 | Acciaio |
| | 40 | 40 | 40 | GW 46 462 | Forata |
| | 70 | 65 | 65 | GW 46 409 | Isolante |
| 405x500x200 | 110 | 65 | | GW 46 403 | Acciaio |
| | 90 | 65 | | GW 46 463 | Forata |
| | 90 | 65 | | GW 46 410 | Isolante |
| 405x650x200 | 110 | 65 | 65 | GW 46 404 | Acciaio |
| | 75 | 65 | 65 | GW 46 464 | Forata |
| | 80 | 65 | 65 | GW 46 411 | Isolante |
| 515x650x250 | 130 | 115 | | GW 46 405 | Acciaio |
| | 95 | 95 | | GW 46 465 | Forata |
| | 80 | 80 | | GW 46 412 | Isolante |
| 585x800x300 | 155 | 135 | 135 | GW 46 406 | Acciaio |
| | 95 | 95 | 95 | GW 46 466 | Forata |
| | 95 | 95 | 95 | GW 46 413 | Isolante |
| 800x1060x350 | 245 | 215 | | GW 46 407 | Acciaio |
| | 120 | 120 | | GW 46 467 | Forata |

COMPLEMENTI DI SERVIZIO

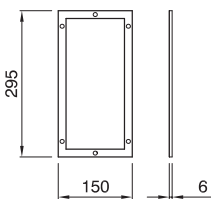

GW 46 449

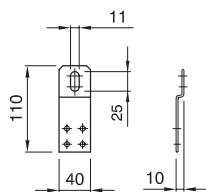

GW 46 446 - GW 46 451

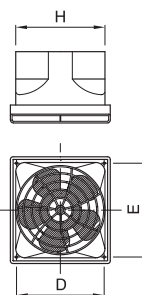

GW 46 448

| Codice | A (mm) | B (mm) | C (mm) | D (mm) | E (mm) | F (mm) | G (mm) | H (mm) |
|------------------|--------|--------|--------|--------|--------|--------|--------|--------|
| GW 46 448 | 131 | 141 | 23,5 | 115 | 123 | 70 | 125 | 117 |
| GW 46 471 | 131 | 141 | 23,5 | 115 | 123 | - | - | - |

